

NOTES: UNLESS OTHERWISE SPECIFIED

1. APPLICABLE STANDARDS AND SPECIFICATIONS;
ANSI Y14.5M, DIMENSIONS AND TOLERANCES
ANSI Y1.1, ABBREVIATIONS
2. WEIGHT CAPACITY: 600 LBS.

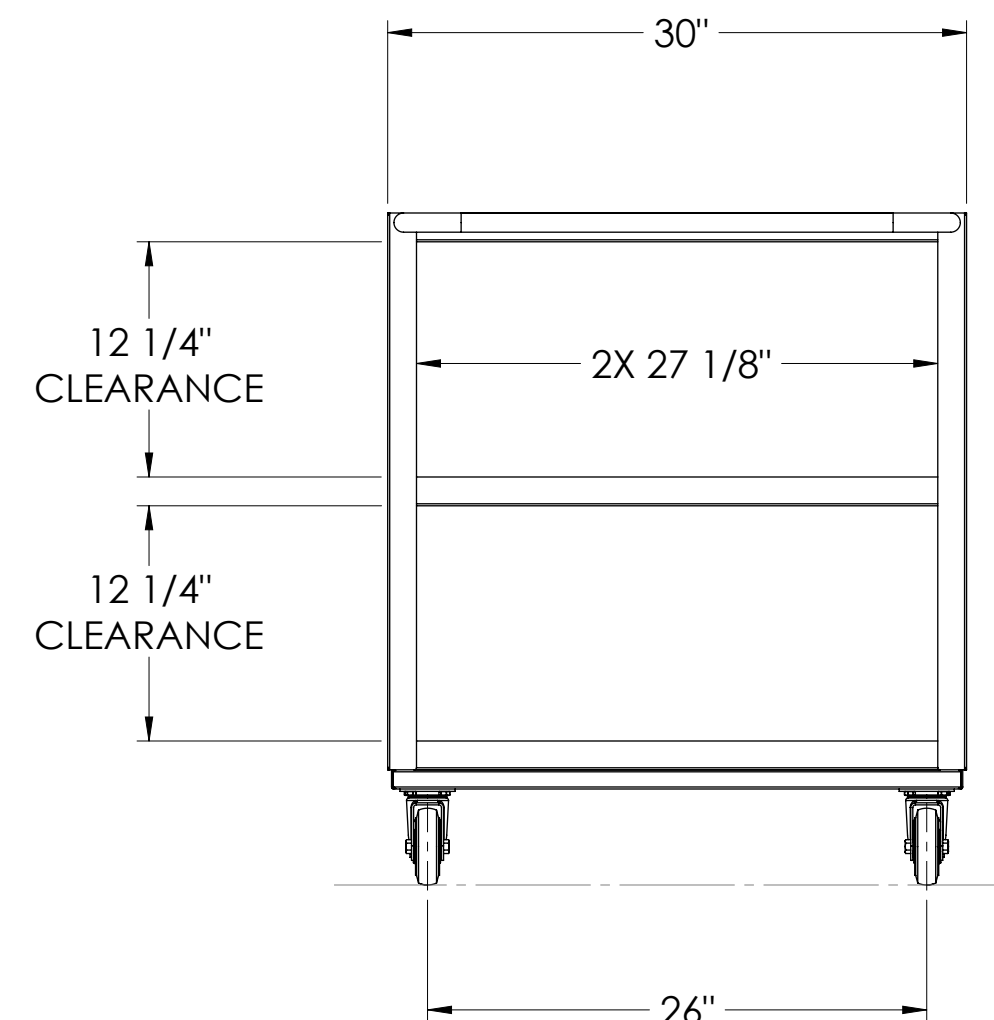
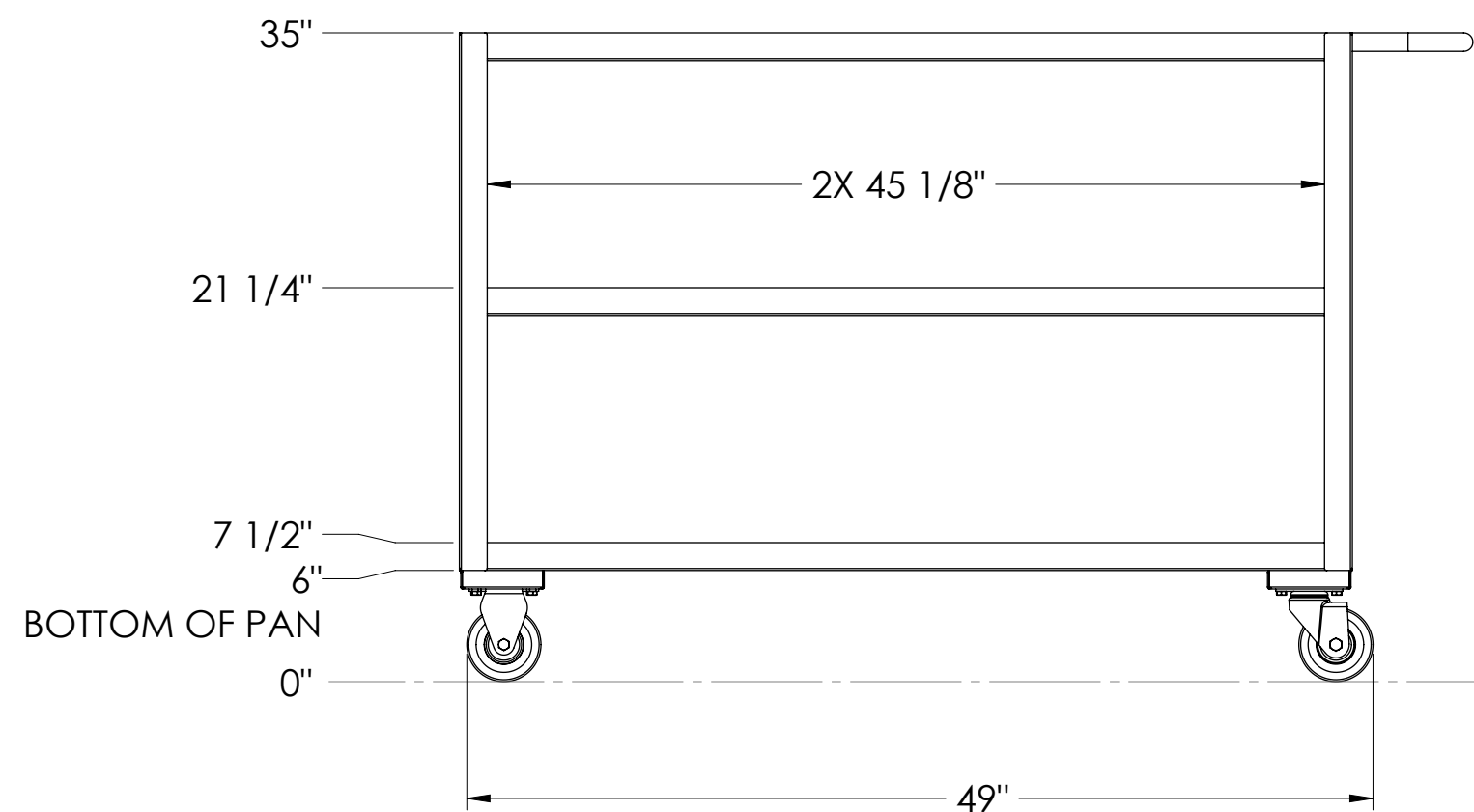
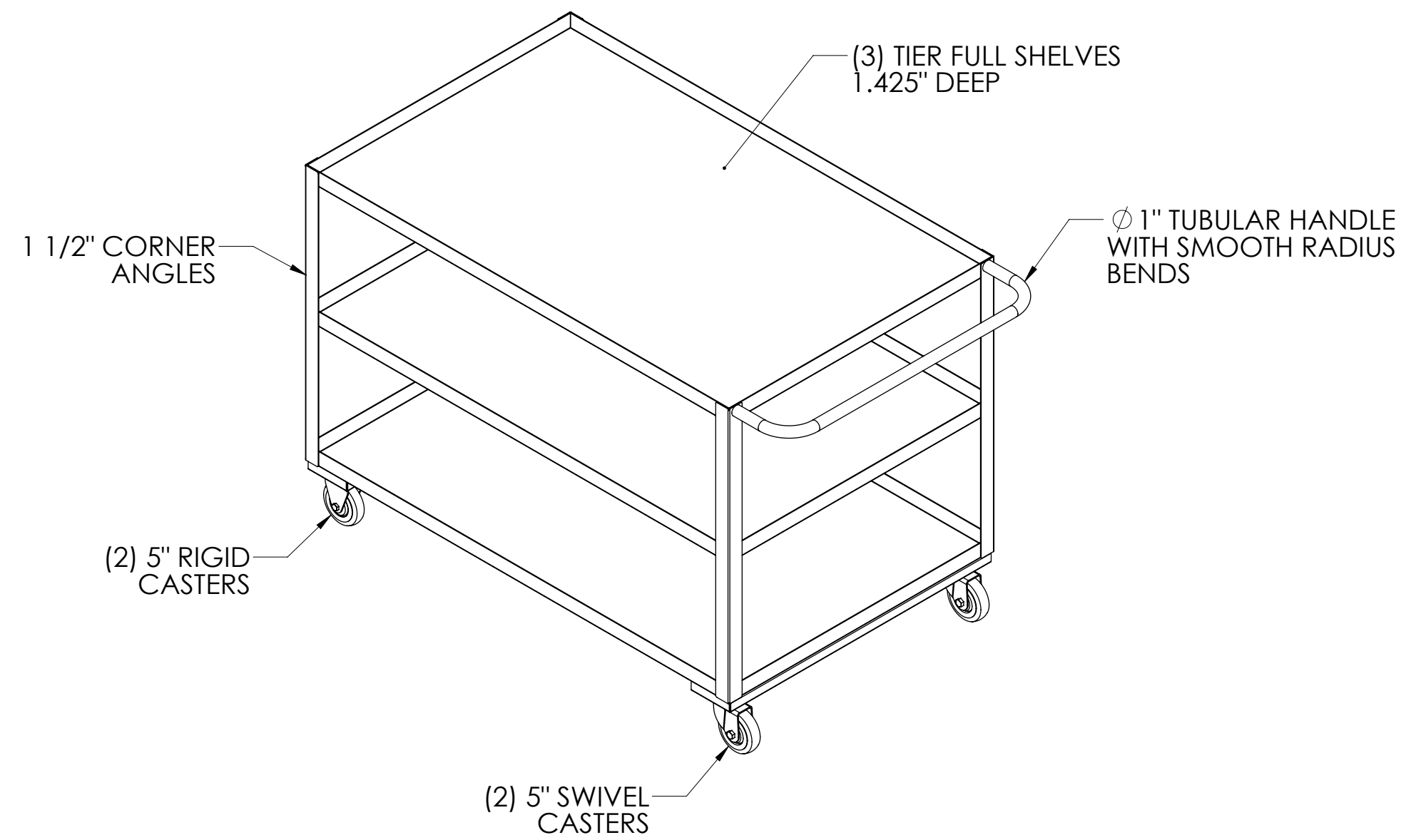
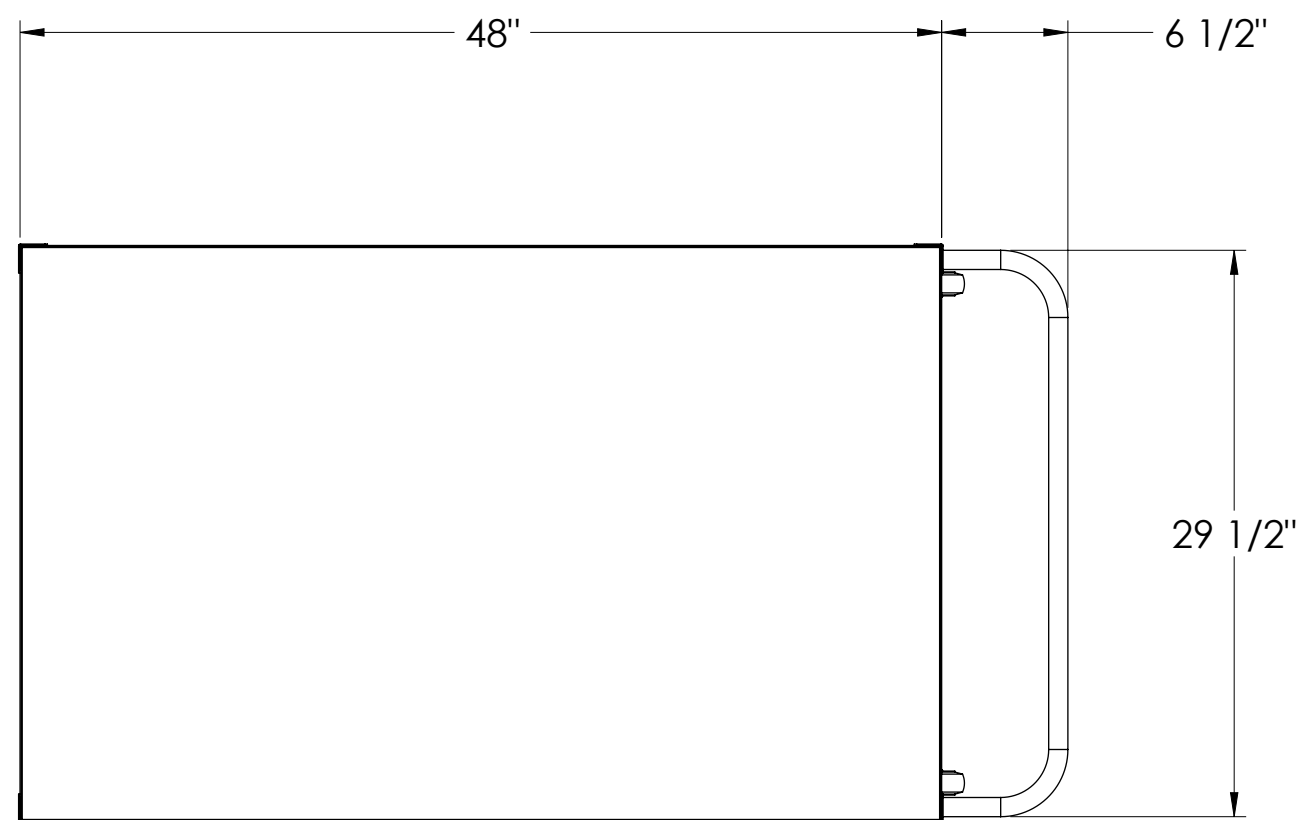

| | | | | | | | | | | | | |
|----------|---|--|--|--|---|--|--|--|--|--|--|--|
| CUSTOMER | <div>CUSTOMER NAME</div> <div>PROJECT</div> <div>PROJECT NAME</div> | | <div>APPROVAL</div> <div>SIGNATURE</div> <div>DATE</div> | | <div>TOLERANCE BLOCK:</div> <div>DIMENSIONS ARE IN INCHES</div> <div>DECIMALS .X ± .1 ANGLES ± 1°</div> <div>DECIMALS .XX ± .01 FRACTIONS ± 1/16"</div> <div>DECIMALS .XXX ± .005</div> <div>DO NOT SCALE DRAWING</div> | | <div>PROPRIETARY</div> <div>THIS DOCUMENT AND THE DATE DISCLOSED HEREIN AND HEREWITH IS NOT TO BE REPRODUCED, USED, OR OTHERWISE DISCLOSED IN WHOLE OR IN PART TO ANYONE WITHOUT WRITTEN AUTHORIZATION FROM MORTECH MFG.</div> | | <div>MOPEC GROUP</div> <div>Mopec</div> <div>MORTECH</div> <div>ELEVATING PATHOLOGY MANUFACTURING</div> | | | |
| | | | | | <div>APPROVALS</div> <div>DRAWN BY</div> <div>CHECKED BY</div> <div>APPROVED BY</div> | | <div>DATE</div> <div>01/21/25</div> | | <div>TITLE</div> <div>MODEL - MXA348-S5</div> <div>STAINLESS STEEL UTILITY CART- 48"L X 30"W</div> | | | |
| | | | | | <div>MATERIAL</div> <div>STAINLESS STEEL, 16 GA.</div> <div>FINISH</div> <div>#4 POLISHED SHELVES</div> | | | | <div>SIZE</div> <div>C</div> <div>DWG NO.</div> <div>MXA348-S5-AP</div> <div>REV</div> <div>X01</div> | | | |
| | | | | | | | | | <div>SCALE</div> <div>1:8</div> <div>NEXT ASSY.</div> <div>SHEET</div> <div>1</div> <div>OF</div> <div>1</div> | | | |